

# ADVANCE TECHNOLOGY FOR PUMPING VISCOUS LIQUIDS



## FOREWORD

“SV INDUSTRIES” rotary pump type “SVX” is a self priming bi-directional positive displacement gear pump in simple two piece cast iron construction with single helical modified profile carbon steel gears shrunk fitted on alloy steel hardened & ground shaft as gear firmly supported on 4 nos of self-lubricated sintered bronzebush bearing. The pump can be run in either direction with change in inlet-outlet port position. The relief valve operations can be reversed by simply changing the R.V. parts on opposite side.

## MATERIAL OF CONSTRUCTION

- ★ Body & covers : IS 210 FG 220 C.I. Grade
- ★ Gears : EN-8
- ★ Seals : Oil seal
- ★ Drive & shafts : EN-19 Hardened & ground
- ★ Bush-Bearing : Sintered bronze
- ★ Key for coupling : Mild steel

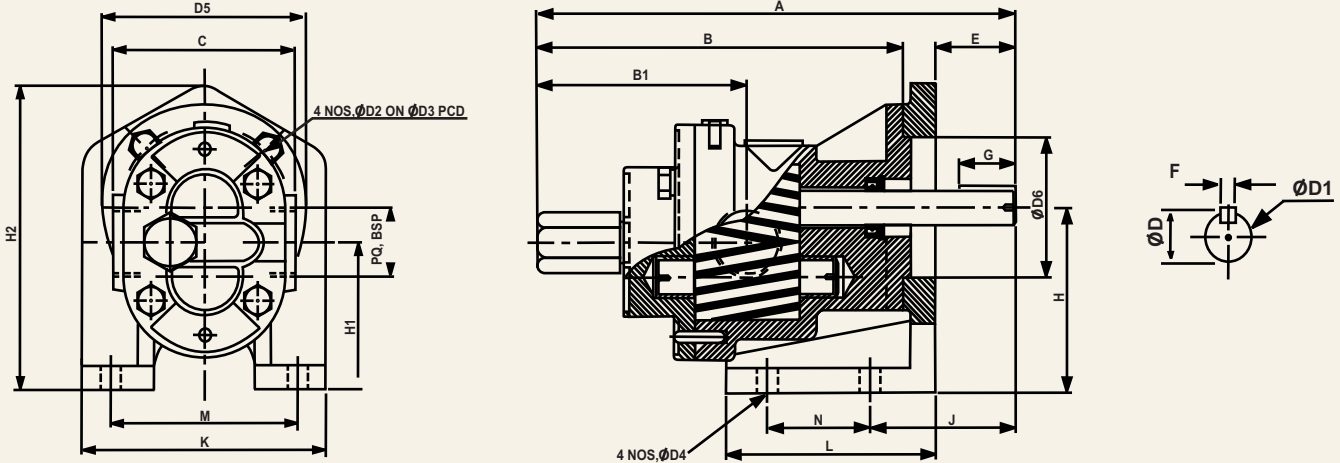

MODEL - SIZE-CAPACITY CHART & POWER FACTORS

PUMP MODEL & SIZE 'P.Q.'BSP	CAPACITY AT 1440 RPM			POWER REQ.			PUMP DIMENSION											Wt. OF BARE PUMP IN KG.	
	LPM	US GPM	M <sup>3</sup> /hr	NO LOAD VISCOUS H.PAT		UNIT H.P.Per Kg Press	Motor H.P. & Frame Size	OVER ALL			MOUNTING & SHAFT								
				200 CST	500 CST			A	B	H <sub>2</sub>	D <sub>1</sub>	D <sub>2</sub>	D <sub>3</sub>	D <sub>4</sub>	D <sub>5</sub>	D <sub>6</sub>	E		F
SVX - 025 1/4" X 1/4"	2.5	0.65	0.15	0.10	0.20	0.10	0.50	130	98	107	11	6.8	8	45	3	63	44	60	1.5
	5	1.30	0.30	0.15	0.22	0.012	71	64	56	77	9.5	59	72	20	18	53.5	78	35	
SVX - 050 1/2" X 1/2"	10	2.05	0.60	0.20	0.27	0.025	0.75	167	129	121	13.5	8.5	8	52	4	71	53	70	2.0
	15	4.00	0.90	0.25	0.32	0.037	80	70	78	80	12	66	82	25	22	58.5	90	40	
SVX - 075 3/4" X 3/4"	20	5.30	1.20	0.35	0.45	0.050	1	215	167	134	16	8.5	10	60	5	80	64	85	4.0
	25	6.65	1.50	0.40	0.50	0.065	80	90	92	90	14	75	92	35	25	66	108	45	
SVX - 100 1" X 1"	35	9.30	2.10	0.50	0.60	0.078	2	235	177	150	19	10.5	10	68	5	90	74	93	4.5
	50	13.30	3.00	0.60	0.70	0.120	90-L	92	105	100	17	83	100	42	27.5	73	120	50	
SVX - 125 1 1/4" X 1 1/4"	60	16.00	3.60	0.75	0.90	0.134	3	271	203	168	22.5	10.5	12	75	6	100	83	105	7.0
	75	20.00	4.50	0.80	0.95	0.170	100-L	100	113	110	20	95	115	51	32	80.5	145	60	
SVX - 150 1 1/2" X 1 1/2"	100	26.60	6.00	0.90	1.05	0.230	5	285	207	190	24.5	10.5	12	85	6	112	96	115	8.5
	125	33.30	7.50	1.00	1.15	0.280	112-M	108	120	135	22	10.5	125	60	35	90	150	70	
SVX - 200 2" X 2"	150	40.00	9.00	1.05	1.20	1.200	7.5	320	215	132	28	14	15	100	8	132	122	140	16.0
	200	53.30	12.00	1.15	1.30	1.300	132-S	142	140	160	25	125	150	85	40	105	190	100	
SVX - 250 2 1/2" X 2 1/2"	300	80.00	18.00	1.35	1.55	1.550	10	421	307	260	31	14	18	115	8	160	133	155	32.5
	350	93.30	21.00	1.50	1.70	1.700	132-M	160	175	182	28	140	165	92	45	128	210	120	

## SPECIAL NOTES

★ For calculating power requirement, multiply unit HP per kg pressure with duty point pressure & add no load viscous HP of appropriate viscosity, adequate margin may be provided to this ★ Higher /lower rating motor can be employed based on duty point power requirement than what is specified as above ★ Bracket in different height available to match the height of electric motor.

“SVX” series pumps are designed to run at 1440 RPM up to viscosity of 500 CST, or higher viscosity it is desirable to reduce for size above 1 1/4". Performance at low speed is always advantageous as it improves efficiency reduces noise level & NPSH & enhances operational life, capacity will reduce in proportion to the speed.

## USES

Due to simple, compact design & with availability of mono-block version these pumps are ideal for OE application of engine lubrication, pumping & heating units, oil filtration, cleaning & cooling system. The pump can also be used for general pump application to handle viscous liquid such as fuel oil, lube oil, LSHS, mineral oil, transformer oil, LDO, paints, varnish, glue, glycerine, soap solution, sugar solution & molasses.



**S V Industries**

Address : 76, Shrinathji Ind. Estate, Kathwada Ring Road,

Nr. Visala Estate, Kathwada Circle,

Ahmedabad-382 430. INDIA

Mobile : +91- 99254 59255

+91- 99092 32555

Email Id : svindustries76@gmail.com

Website : www.svindustries.co

# ROTARY GEAR PUMPS

**Sure Solution**  
for **ALL** Viscous Liquid Pumping

**SERIES : SVX**



*“ Let Our Quality Speck Itself ”*



**S V INDUSTRIES**